

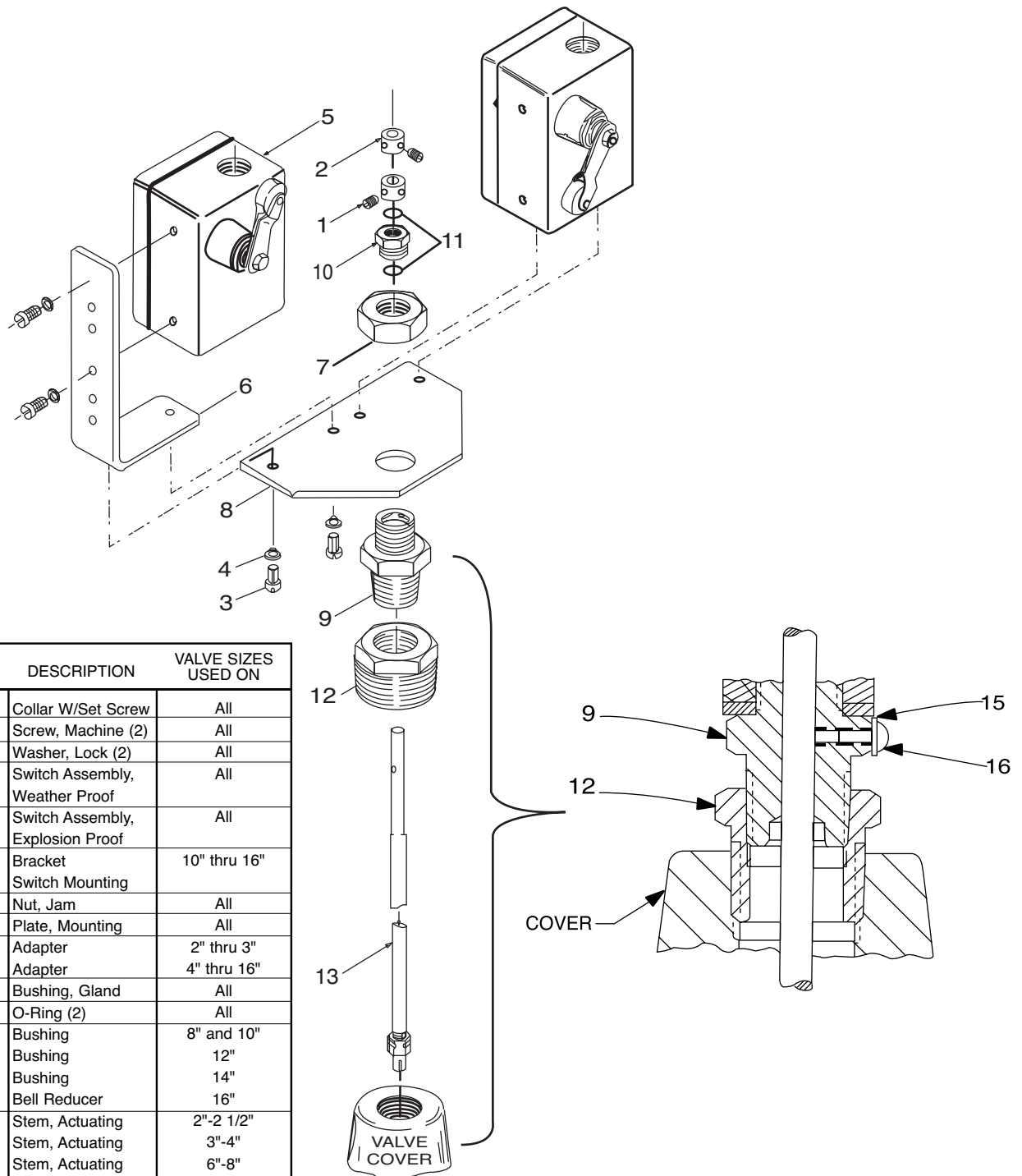

X105L

Limit Switch Assembly



ITEM	PART NUMBER	DESCRIPTION	VALVE SIZES USED ON
1-2	20441701E	Collar W/Set Screw	All
3	67578-21B	Screw, Machine (2)	All
4	67584-23F	Washer, Lock (2)	All
5	34637K	Switch Assembly, Weather Proof	All
	34633J	Switch Assembly, Explosion Proof	All
6	64310G	Bracket Switch Mounting	10" thru 16"
7	67815-06J	Nut, Jam	All
8	63674G	Plate, Mounting	All
9	2838201J	Adapter	2" thru 3"
	2838202G	Adapter	4" thru 16"
10	63398C	Bushing, Gland	All
11	00951E	O-Ring (2)	All
12	67644-17K	Bushing	8" and 10"
	67644-18H	Bushing	12"
	67644-19F	Bushing	14"
	67656-91J	Bell Reducer	16"
13	89701-01F	Stem, Actuating	2"-2 1/2"
	89701-02D	Stem, Actuating	3"-4"
	89701-03B	Stem, Actuating	6"-8"
	89701-04K	Stem, Actuating	10"-12"-14"
	89701-05G	Stem, Actuating	16"
15	6551201H	Fiber Wshr	All
16	6824421K	Screw 8-32 x 3/8	All

When ordering parts, please specify:

- Item Number
- Description
- Part Number